



49 Greencroft Street, Salisbury, Wiltshire, SP1 1JF

A nicely presented 4 bed, 3 storey Victorian townhouse with an attractive garden, available on a long-term basis.

- Victorian Town House
- Three Storey
- Four Bedrooms
- Two Reception Rooms
- Sunny Rear Garden
- Gas Heating
- Long Term Tenancy
- Unfurnished
- Shower Room and Ground Floor WC
- Close to Park

£1,450 PCM

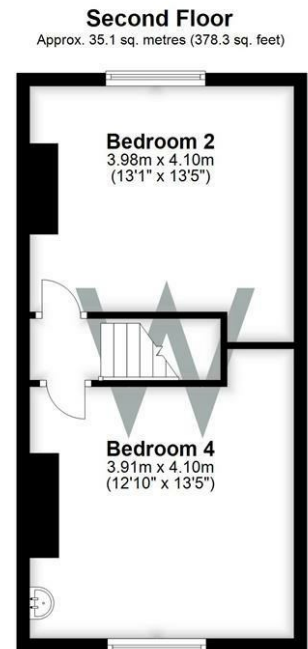
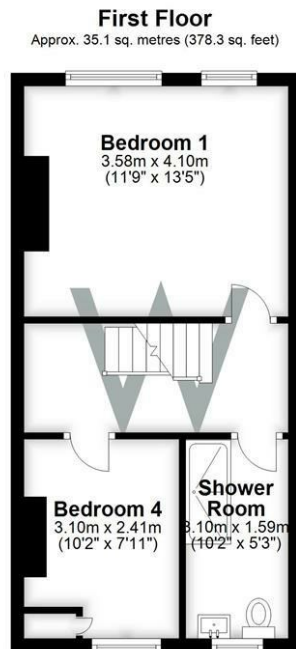
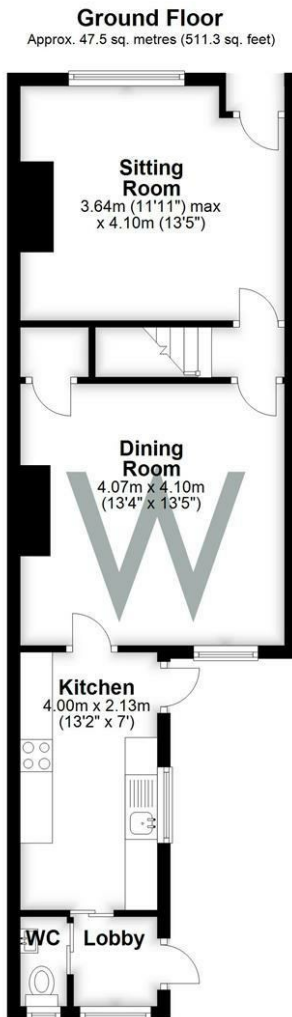

WHITES

Castle Chambers, 47 Castle Street, Salisbury,
Wiltshire, SP1 3SP

Tel: 01722 336422/Option 2

www.hwwhite.co.uk

email: lettings-management@hwwhites.co.uk

Energy Efficiency Rating		
	Current	Potential
Very energy efficient - lower running costs		
(92 plus) A		
(81-91) B		
(69-80) C		
(55-68) D		
(39-54) E		
(21-38) F		
(1-20) G		
Not energy efficient - higher running costs		
England & Wales	EU Directive 2002/91/EC	

Environmental Impact (CO ₂) Rating		
	Current	Potential
Very environmentally friendly - lower CO ₂ emissions		
(92 plus) A		
(81-91) B		
(69-80) C		
(55-68) D		
(39-54) E		
(21-38) F		
(1-20) G		
Not environmentally friendly - higher CO ₂ emissions		
England & Wales	EU Directive 2002/91/EC	